



25 TAILLEFER ROAD, CORBEIL, ONTARIO P0H 1K0
TEL.: (705) 752-2740 FAX.: (705) 752-2452
municipality@eastferris.ca

NOTICE OF COMPLETE APPLICATION AND PUBLIC MEETING – Minor Variance Application

Applicant: Marie Lynn & Daniel Savage
File No.: A-2025-02
Civic Address: 688 Quae Quae Road, Corbeil

IN THE MATTER of an application for a minor variance under Section 45 of the Planning Act by: Marie Lynn and Daniel Savage for their parcel of land described as 688 Quae Quae Road in the Municipality of East Ferris. The Committee of Adjustment has appointed **March 19th, 2025 at 5:00 p.m** for the purpose of considering this application. This meeting will be held in the Council Chambers at the Municipal Office at **25 Taillefer Road, Corbeil, ON**. If you only wish to watch the meeting, please visit the Municipality of East Ferris YouTube channel to watch the live stream. This meeting is being held in accordance with *Planning Act* regulations.

PURPOSE AND EFFECT OF APPLICATION: The owner is applying to permit a variance to Zoning By-law 2021-60. The applicant is seeking a minor variance to allow for a reduction in lot size from 2.0 acres to 1.8 acre. **Please see the sketch below.**

ADDITIONAL INFORMATION relating to this application for a minor variance is available for inspection during regular office hours at the Municipal Office in Corbeil or by contacting municipal staff. If you wish to be notified of the decision of the Municipality of East Ferris Committee of Adjustment in respect of this application, you must submit a written request to the **Municipality of East Ferris Committee of Adjustment, 25 Taillefer Rd, Corbeil, Ontario P0H 1K0**. This will entitle you to be advised of any further correspondence, including Ontario Land Tribunal (OLT) hearings, if applicable. Even if you are the successful party, you should request a copy of the decision since the decision of the Committee of Adjustment may be appealed to the including Ontario Land Tribunal (OLT) by the applicant or another member of the public.

The land which is the subject of this application for a Minor Variance is the subject of an application under the Planning Act for Consent (East Ferris File No. B-2025-03).

Municipality of East Ferris
Committee of Adjustment
25 Taillefer Rd, Corbeil, Ontario
P0H 1K0

Dated this 5th day of March, 2025

Greg Kirton
Director of Community Services
Municipality of East Ferris

Key Plan (Not to Scale)

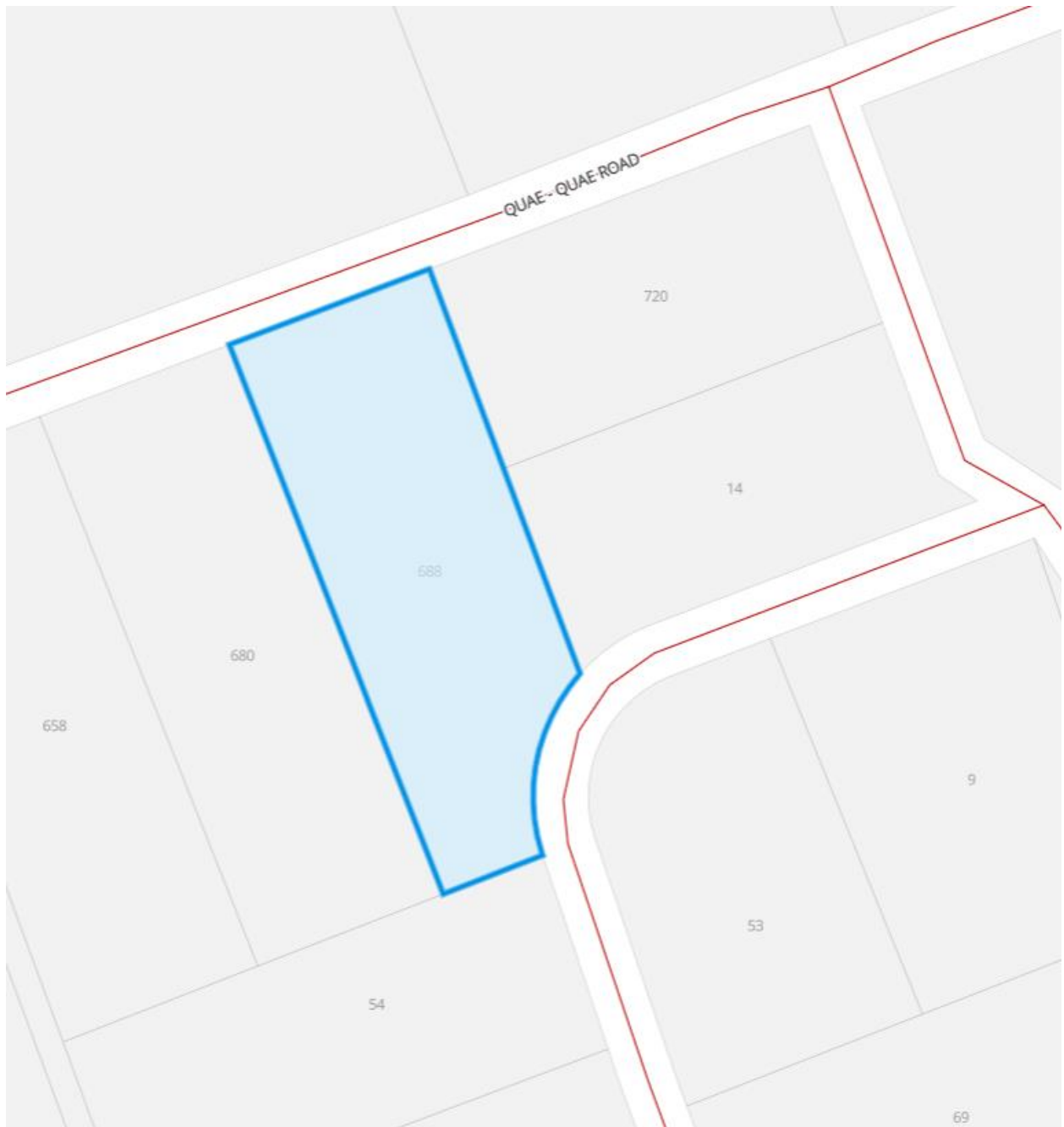

A hand-drawn survey map showing several land parcels and their boundaries. The map includes bearings and distances for various boundary segments.

- Top Boundary:** A horizontal line at the top with a bearing of $N20^{\circ}09'W$ and a distance of 74.981 .
- Left Boundary:** A vertical line on the left with a bearing of $N20^{\circ}04'W$ and a distance of 60.136 . Below this segment, there are calculations: $R = 71.021$, $A = 21.548$, $C = 30.791$, and $N24^{\circ}16'43''E$.
- Right Boundary:** A vertical line on the right with a bearing of $N24^{\circ}40'30''E$ and a distance of 71.730 . Below this segment, there are calculations: $R = 71.021$, $A = 29.0$, $C = 28.9$, and $N24^{\circ}21'E$.
- Bottom Boundary:** A curved line at the bottom labeled "WAUKESHA". It has several points with bearings and distances: $S1B$, $S1B$, $S1B$, $S1B$, and $S1B$. There are also distances like 156.924 , 111.361 , 192.014 , and 30.117 .
- Internal Features:** A stream labeled "STREAM" flows through the center. A proposed lot is indicated as "Proposed lot 1.8 ACRES".
- Other Labels:** "QUEEN" is written at the top left. "S.B." appears multiple times along the boundaries.